

# CAPELLA STUDIO FLOOR PLAN

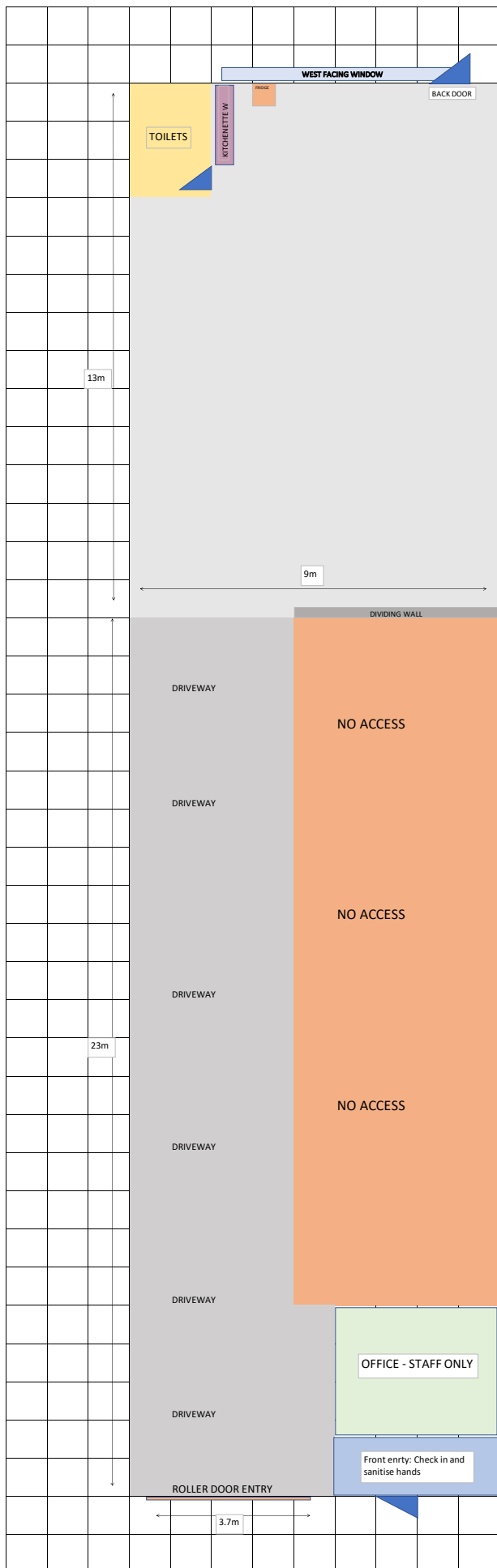

**Address:** 1a Capella Crescent  
Moorabbin 3189  
30 minutes from the city, 25 kilometres in distance

**Size:** 130 sq meters (plus driveway)

**Access:** 3.7m wide by 5m tall Roller door access. There is vehicle access all the way into the shooting space for ease of unloading equipment and the ability to photograph vehicles.

2 private car parks at front of studio as well as indoor parking available upon request. Street parking is all day no restrictions.

**Amenities:**

Fast WIFI, Kitchenette, coffee machine, fridge and break out space, heaters and fans.

**Included equipment:**

2 x poly boards with stands, sand bags, tether bench with monitor and Mac USB-C laptop charging, milk crates, 4 large trestle tables and power cords.

Ceiling height is 5 to 5.5 meters

Great afternoon natural sunlight from large window as well as skylight roof panels.

**Optional equipment for hire:**

- 8x8 foot scrim and stands
- Paper roll support system (white roll included)
- Use of coloured boards for product/food